

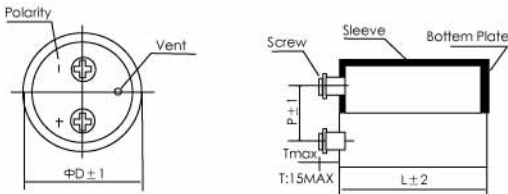

Dimensions and case code for screw type

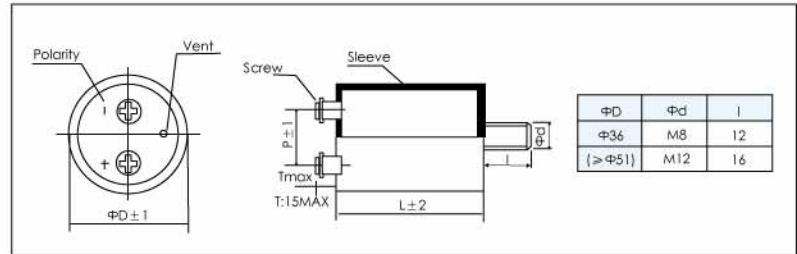
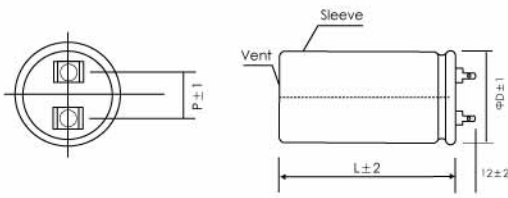

LUG

ΦD	P	ΦD	P
36	14	51	20
40	14	64	25

SCREW

Case code	ΦD	L	P	I type bracket		Y type bracket	
				W1	W2	W3	W4
A5	36	53	12.7	48.0	58.0	--	--
A6	36	65	12.7	48.0	58.0	--	--
A8	36	83	12.7	48.0	58.0	--	--
A10	36	100	12.7	48.0	58.0	--	--
A12	36	121	12.7	48.0	58.0	--	--
C8	51	83	22.0	(68.0)	(80.0)	63.5	73.0
C10	51	100	22.0	(68.0)	(80.0)	63.5	73.0
C11	51	109	22.0	(68.0)	(80.0)	63.5	73.0
C12	51	121	22.0	(68.0)	(80.0)	63.5	73.0
D10	64	100	28.6	(81.0)	(93.0)	76.2	85.1
D11	64	105	28.6	(81.0)	(93.0)	76.2	85.1
D12	64	121	28.6	(81.0)	(93.0)	76.2	85.1
D15	64	144	28.6	(81.0)	(93.0)	76.2	85.1
E10	77	100	32.0	(93.5)	(106.0)	88.9	98.4
E12	77	121	32.0	(93.5)	(106.0)	88.9	98.4
E15	77	144	32.0	(93.5)	(106.0)	88.9	98.4
E16	77	160	32.0	(93.5)	(106.0)	88.9	98.4
F15	90	145	32.0	(108.0)	(120.5)	101.6	111.1
F16	90	161	32.0	(108.0)	(120.5)	101.6	111.1
C7R	51	64	22.0	(68.0)	(80.0)	63.5	73.0
C8R	51	75	22.0	(68.0)	(80.0)	63.5	73.0
C10R	51	96	22.0	(68.0)	(80.0)	63.5	73.0
C12R	51	115	22.0	(68.0)	(80.0)	63.5	73.0
C13R	51	130	22.0	(68.0)	(80.0)	63.5	73.0
D10R	64	96	22.0	(81.0)	(93.0)	76.2	85.1
D12R	64	115	28.6	(81.0)	(93.0)	76.2	85.1
D13R	64	130	28.6	(81.0)	(93.0)	76.2	85.1
D16R	64	155	28.6	(81.0)	(93.0)	76.2	85.1
D20R	64	195	28.6	(81.0)	(93.0)	76.2	85.1
E10R	77	96	28.6	(93.5)	(106.0)	88.9	98.4
E12R	77	115	32.0	(93.5)	(106.0)	88.9	98.4
E13R	77	130	32.0	(93.5)	(106.0)	88.9	98.4
E16R	77	155	32.0	(93.5)	(106.0)	88.9	98.4
E17R	77	171	32.0	(93.5)	(106.0)	88.9	98.4
E20R	77	195	32.0	(93.5)	(106.0)	88.9	98.4
F13R	90	131	32.0	(108.0)	(120.5)	101.6	111.1
F16R	90	157	32.0	(108.0)	(120.5)	101.6	111.1
F17R	90	171	32.0	(108.0)	(120.5)	101.6	111.1
F20R	90	196	32.0	(108.0)	(120.5)	101.6	111.1
F24R	90	236	32.0	(108.0)	(120.5)	101.6	111.1
G18R	101	175	41.5	(32)	-	115	127
G20R	101	196	41.5	(32)	-	115	127
G24R	101	237	41.5	(32)	-	115	127

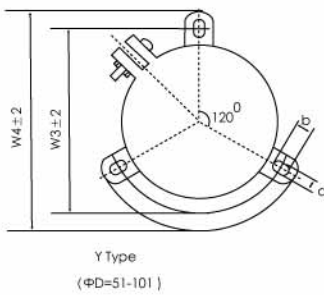
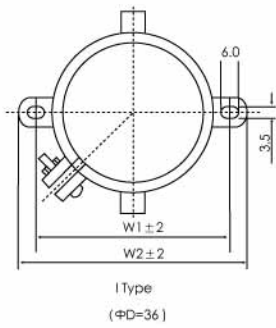

ΦD	a	b
51-90	7	4.5
101	8	4.5

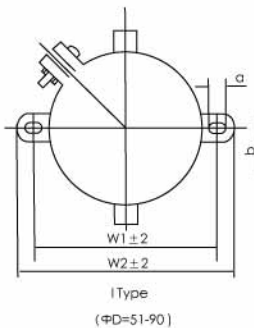

ΦD	a	b
51-77	6	4.5
101	7	5

Hexagon-head bolt
 Case code(A to F): M5X10
 Case code(G): M6X12(P=32.0)
 M8X16(P=41.5)